

**MTG 2500 S/FSC/3,5m/45°**

**4,035,980**

# MTG 2500S /FSC/3.5m/45° (4,035,980)

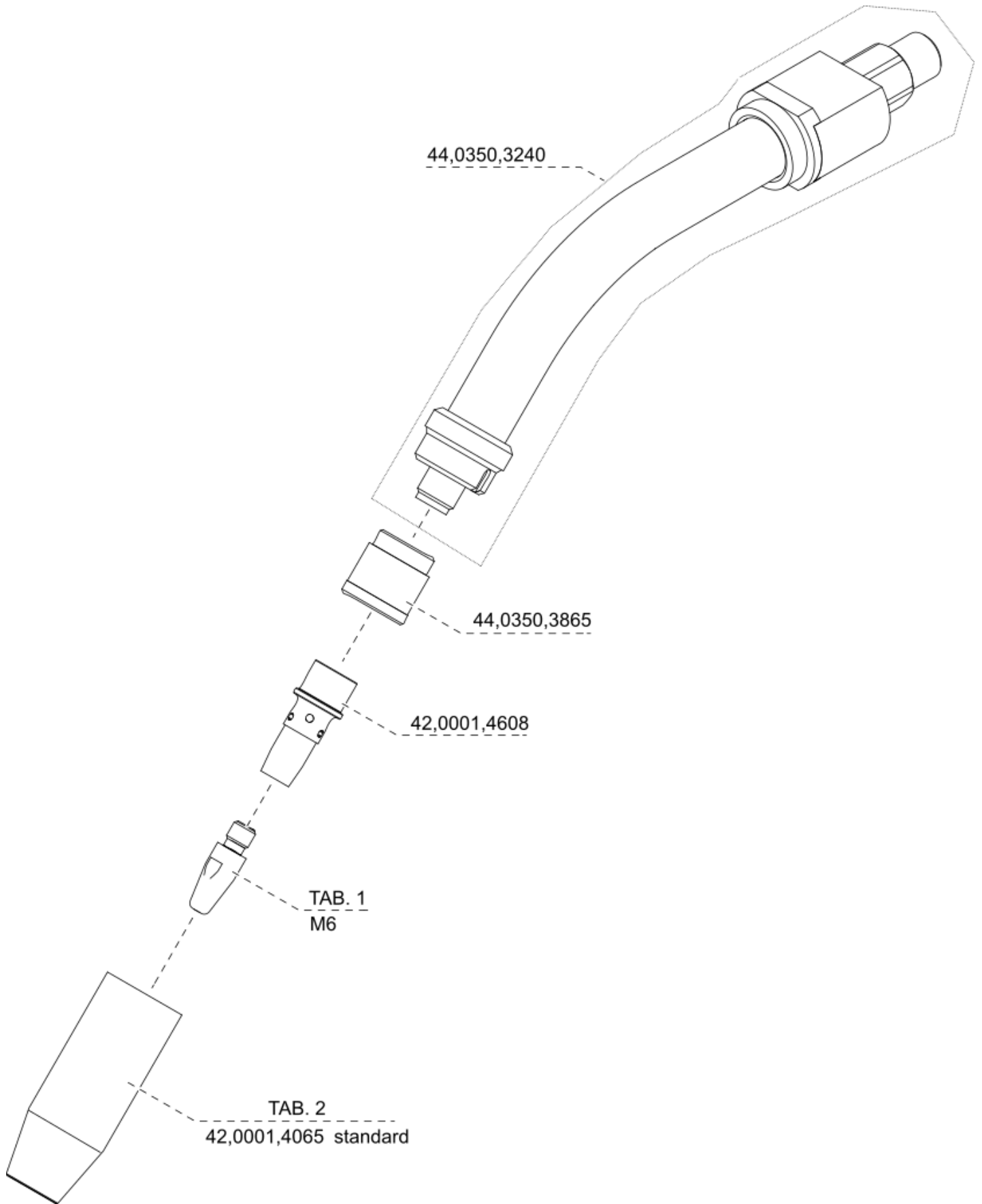

# MTG 2500S /FSC/3.5m/45° (4,035,980)

## TAB. D

43,0004,1797 3,5m MTG 2500S  
 43,0004,1798 4,5m

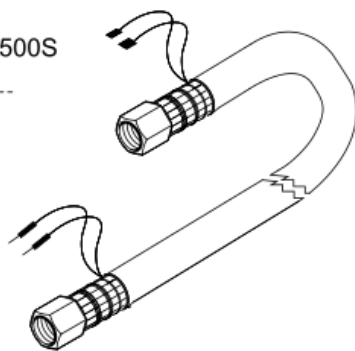

Tab. D

Tab. 3

42,0300,2149

42,0407,0100

43,0004,5000 (2x)

40,0001,0125 (2x)

44,0350,3244

44,0350,3435

Tab. 4

42,0401,1099

42,0402,0258

Tab. 3

# MTG 2500S /FSC/3.5m/45° (4,035,980)

## MTG 2100S/2500S - Userinterface

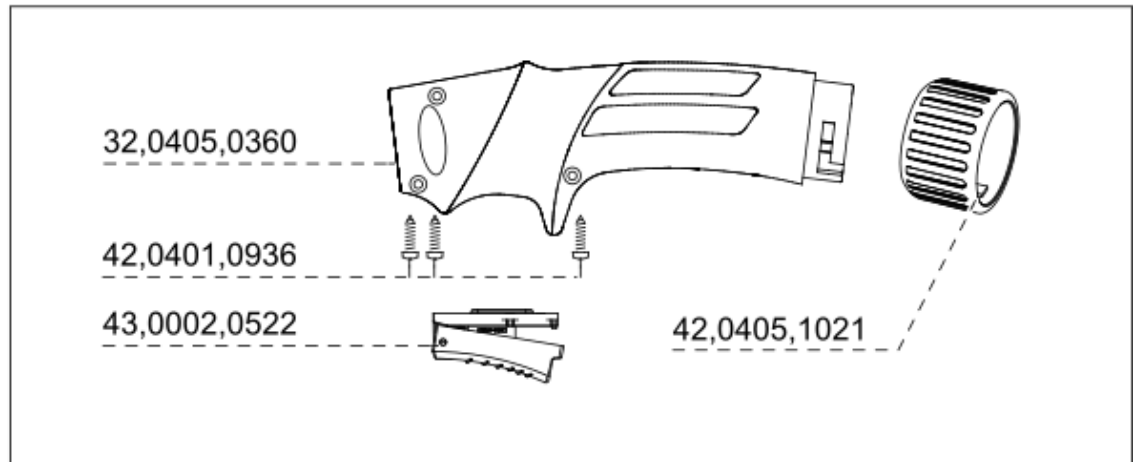

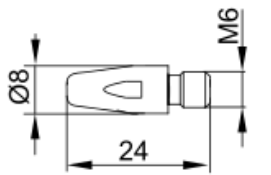
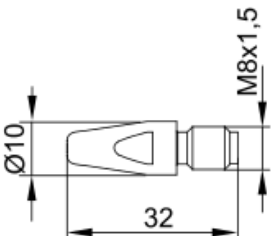
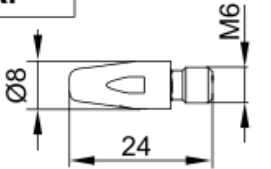
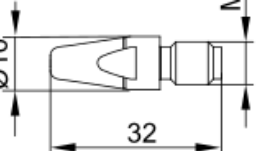

# MTG 2500S /FSC/3.5m/45° (4,035,980)

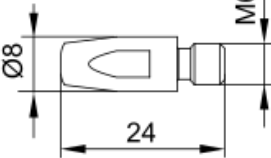
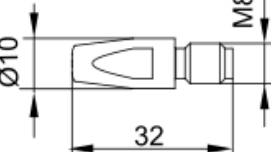

TAB. 1 <b>CuCrZr</b>		Ø mm	Ø inch	Part No.
		0,6	0,023	42,0001,4928
		0,7	0,027	42,0001,6524,10
		0,8	0,030	42,0001,4461,10
		0,9	0,035	42,0001,4462,10
		1,0	0,040	42,0001,4463,10
		1,1	0,043	42,0001,6527,10
		1,2	0,045	42,0001,4464,10
		1,3	0,051	42,0001,6529,10
		1,4	0,052	42,0001,4465,10
		1,5	0,059	42,0001,6522,10
		1,6	0,062	42,0001,4466,10
		0,7	0,027	42,0001,6482,10
		0,8	0,030	42,0001,6464,10
		0,9	0,035	42,0001,6465,10
		1,0	0,040	42,0001,6466,10
		1,1	0,043	42,0001,6483,10
		1,2	0,045	42,0001,6467,10
		1,3	0,051	42,0001,6484,10
		1,4	0,052	42,0001,6468,10
		1,5	0,059	42,0001,6485,10
		1,6	0,062	42,0001,6469,10
		1,8	0,071	42,0001,6470,10
	2,0	0,078	42,0001,6471,10	
	2,4	0,095	42,0001,6472,10	
	2,8	0,110	42,0001,4642,10	
<b>Al</b> 		0,8	0,030	42,0001,6525,10
		1,0	0,040	42,0001,6526,10
		1,2	0,045	42,0001,6528,10
		1,6	0,062	42,0001,6523,10
<b>Al</b> 		0,8	0,030	42,0001,6537,10
		1,0	0,040	42,0001,4750,10
		1,2	0,045	42,0001,4751,10
		1,6	0,062	42,0001,4752,10

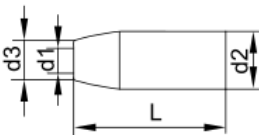
TAB. 1 <b>E-Cu</b>		Ø mm	Ø inch	Part No.
		0,9	0,035	42,0001,7025,10
		1,0	0,040	42,0001,7026,10
		1,2	0,045	42,0001,7027,10
		0,9	0,035	42,0001,7028,10
		1,0	0,040	42,0001,7029,10
		1,2	0,045	42,0001,7030,10

# MTG 2500S /FSC/3.5m/45° (4,035,980)

<b>TAB. 2</b> 													
		<b>d1</b>		<b>d2</b>		<b>d3</b>		<b>L</b>		<b>Part No.</b>			
		mm	inch	mm	inch	mm	inch	mm	inch				
<b>MTG 2500S</b>	M20x2	18	0.71	22	0.86	22	0.86	58	2.28	42,0001,4055	Fe		
		12	0.47	22	0.86	15,1	0.59	58	2.28	42,0001,4065	Fe	standard MTG 2500S	
		10	0.39	22	0.86	13,0	0.51	58	2.28	42,0001,4084	Fe		
		10	0.39	22	0.86	13,0	0.51	54	2.13	42,0001,4083	Fe		
		15	0.59	22	0.86	18,3	0.72	58	2.28	42,0001,4493	Fe		
		12	0.47	22	0.86	15,1	0.59	56	2.20	42,0001,4477	Fe		
<b>MTG 2100S</b>		12	0.47	22	0.86	15,1	0.59	58	2.28	42,0001,4498	Al		
		12	0.47	20	0.79	15,1	0.59	59	2.32	44,0350,4128	Fe	standard MTG 2100S	

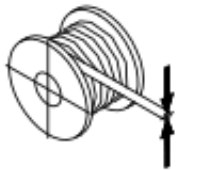
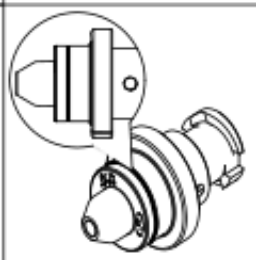
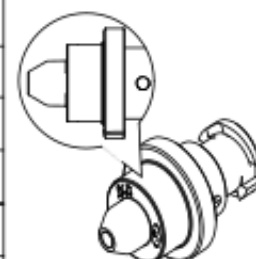
**MTG 2500S /FSC/3.5m/45° (4,035,980)**

<b>Tab. 4</b>					
<b>MTG / MTW</b>					
 Ø mm   Ø inch		<b>Fe / CrNi</b>	<b>Alu / CuSi</b>	<b>colour</b>	
0,8	.031		44,0350,3314	grey	
0,8	.031	44,0350,3315		grey	
0,9-1,0	.039	44,0350,3317		blue	
1,2	.047	44,0350,3318		red	
1,4-1,6	.062	44,0350,3320		black	
2,0	.078		44,0350,3321	green	
2,4	.095		44,0350,4245	brown	 only stuck
2,0	.078	42,0001,4589			
2,4	.095				
2,8	.110				

# MTG 2500S /FSC/3.5m/45° (4,035,980)

**Tab. 3**

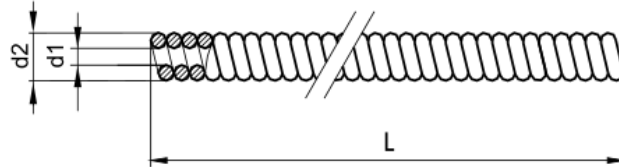

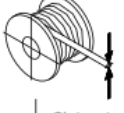
material			d1		d2		Part No. L		Part No. L	Part No. L		
	Ø mm	Ø inch	mm	inch	mm	inch	5m	16.4feet	15m	49.2feet	50m	160feet
Steel liner	0,8	.030	1,4	.055	4,4	.176	40,0002,0040,005		40,0002,0040,015		40,0002,0040,050	
Steel liner	0,9-1,0	.035/.040	1,6	.062	4,8	.189	40,0002,0041,005		40,0002,0041,015		40,0002,0041,050	
Steel liner	1,2	.045	1,9	.074	4,9	.192	40,0002,0042,005		40,0002,0042,015		40,0002,0042,050	
Steel liner	1,4-1,6	.052/.062	2,5	.098	4,9	.192	40,0002,0043,005		40,0002,0043,015		40,0002,0043,050	
CrNi liner	0,8	.030	1,4	.055	4,4	.176	40,0002,0044,005		40,0002,0044,015		40,0002,0044,050	
CrNi liner	0,9-1,0	.035/.040	1,6	.062	4,8	.189	40,0002,0045,005		40,0002,0045,015		40,0002,0045,050	
CrNi liner	1,2	.045	1,9	.074	4,9	.192	40,0002,0046,005		40,0002,0046,015		40,0002,0046,050	
CrNi liner	1,4-1,6	.052/.062	2,5	.098	4,9	.192	40,0002,0047,005		40,0002,0047,015		40,0002,0047,050	
Steel liner coated	0,8	.030	1,4	.055	4,4	.176	40,0002,0052,005		40,0002,0052,015		40,0002,0052,050	
Steel liner coated	0,9-1,0	.035/.040	1,6	.062	4,8	.189	40,0002,0053,005		40,0002,0053,015		40,0002,0053,050	
Steel liner coated	1,2	.045	1,9	.074	4,9	.192	40,0002,0054,005		40,0002,0054,015		40,0002,0054,050	
Steel liner coated	1,4-1,6	.052/.062	2,5	.098	4,9	.192	40,0002,0055,005		40,0002,0055,015		40,0002,0055,050	

**Tab. 3**

**combi liner W AL**

**combi liner G AL**

**combi inner liner G**

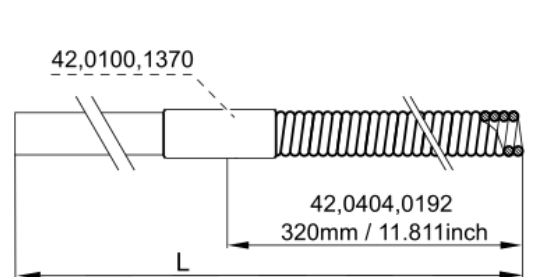
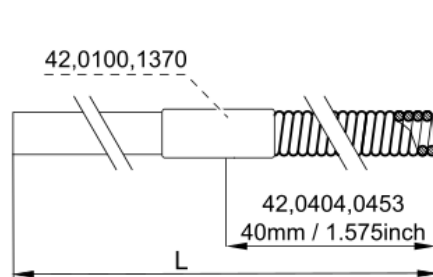
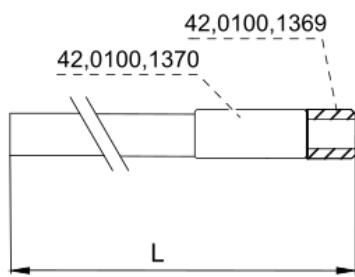

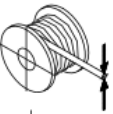
		L		d1		d2		combi liner W AL	combi liner G AL	combi inner liner G
Ø mm	Ø inch	m	feet	mm	inch	mm	inch	Part No.	Part No.	Part No.
0,8	.030	2,0	6.5	1,2	.059	4,7	.185	44,0350,3388	44,0350,3400	44,0350,5550
0,8	.030	3,8	12.4	1,2	.059	4,7	.185	44,0350,3392	44,0350,3404	44,0350,5513
0,8	.030	4,8	15.7	1,2	.059	4,7	.185	44,0350,3396	44,0350,3408	44,0350,5518
0,9-1,0	.035/.040	2,0	6.5	1,5	.062	4,7	.185	44,0350,3389	44,0350,3401	44,0350,5551
0,9-1,0	.035/.040	3,8	12.4	1,5	.062	4,7	.185	44,0350,3393	44,0350,3405	44,0350,5514
0,9-1,0	.035/.040	4,8	15.7	1,5	.062	4,7	.185	44,0350,3397	44,0350,3409	44,0350,5519
1,2	.045	2,0	6.5	1,8	0.74	4,7	.185	44,0350,3390	44,0350,3402	44,0350,5552
1,2	.045	3,8	12.4	1,8	0.74	4,7	.185	44,0350,3394	44,0350,3406	44,0350,5515
1,2	.045	4,8	15.7	1,8	0.74	4,7	.185	44,0350,3398	44,0350,3410	44,0350,5520
1,4-1,6	.052/.062	2,0	6.5	2,4	.098	4,7	.185	44,0350,3391	44,0350,3403	44,0350,5553
1,4-1,6	.052/.062	3,8	12.4	2,4	.098	4,7	.185	44,0350,3395	44,0350,3407	44,0350,5516
1,4-1,6	.052/.062	4,8	15.7	2,4	.098	4,7	.185	44,0350,3399	44,0350,3411	44,0350,5521
2,0	.045	2,0	6.5	1,2	.059	4,7	.185	44,0350,3615	44,0350,3618	44,0350,5554
2,0	.045	3,8	12.4	3,0	.118	4,7	.185	44,0350,3616	44,0350,3619	44,0350,5517
2,0	.045	4,8	15.7	3,0	.118	4,7	.185	44,0350,3617	44,0350,3620	44,0350,5522



# MTG 2500S /FSC/3.5m/45° (4,035,980)

**Tab. 3.1**

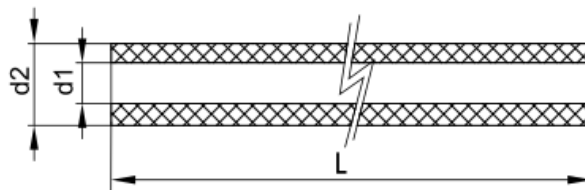

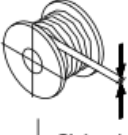
material			d1		d2		Part No. L		Part No. L		Part No. L	
	Ø mm	Ø inch	mm	inch	mm	inch	10m 32.8feet	30m 98feet	100m 328feet			
Graphit	0,8	.030	1,2	.047	4,7	.185	40,0001,0529,010	40,0001,0529,030	40,0001,0529,100			
Graphit	0,9-1,0	.035-.040	1,5	.059	4,7	.185	40,0001,0530,010	40,0001,0530,030	40,0001,0530,100			
Graphit	1,2	.045	1,8	.070	4,7	.185	40,0001,0531,010	40,0001,0531,030	40,0001,0531,100			
Graphit	1,4-1,6	.052-1/16	2,4	.094	4,7	.185	40,0001,0532,010	40,0001,0532,030	40,0001,0532,100			
Graphit	0,8	5/64	3,0	.118	4,7	.185	40,0001,0533,010	40,0001,0533,030	40,0001,0533,100			

# MTG 2500S /FSC/3.5m/45° (4,035,980)

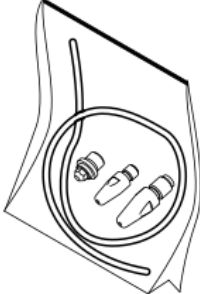
Basic kit 250i / 320i / 400i / 500i / 700i	Ø mm   Ø inch		m   feet		Fe MTG / MTW Part No.	CrNi MTG / MTW Part No.	Alu MTW Part No.	CuSi MTW Part No.	Alu/CuSi MTG Part No.
		0,6	.023	5,0	11.5	44,0350,5296	X	X	
0,8		.030	5,0	11.5	44,0350,5117	44,0350,5158	44,0350,5135		44,0350,5144
0,9		.035	5,0	14.8	44,0350,5118	44,0350,5159	44,0350,5136		44,0350,5145
1,0		.040	5,0	11.5	44,0350,5119	44,0350,5160	44,0350,5137		44,0350,5146
1,2		.047	5,0	14.8	44,0350,5120	44,0350,5161	44,0350,5138		44,0350,5147
1,4		.052	5,0	11.5	44,0350,5121	44,0350,5162	44,0350,5139		44,0350,5148
1,6		.062	5,0	14.8	44,0350,5122	44,0350,5163	44,0350,5140		44,0350,5149
2,0		.078	5,0	14.8	X	X	44,0350,5141		X

**MTG 2500S /FSC/3.5m/45° (4,035,980)**

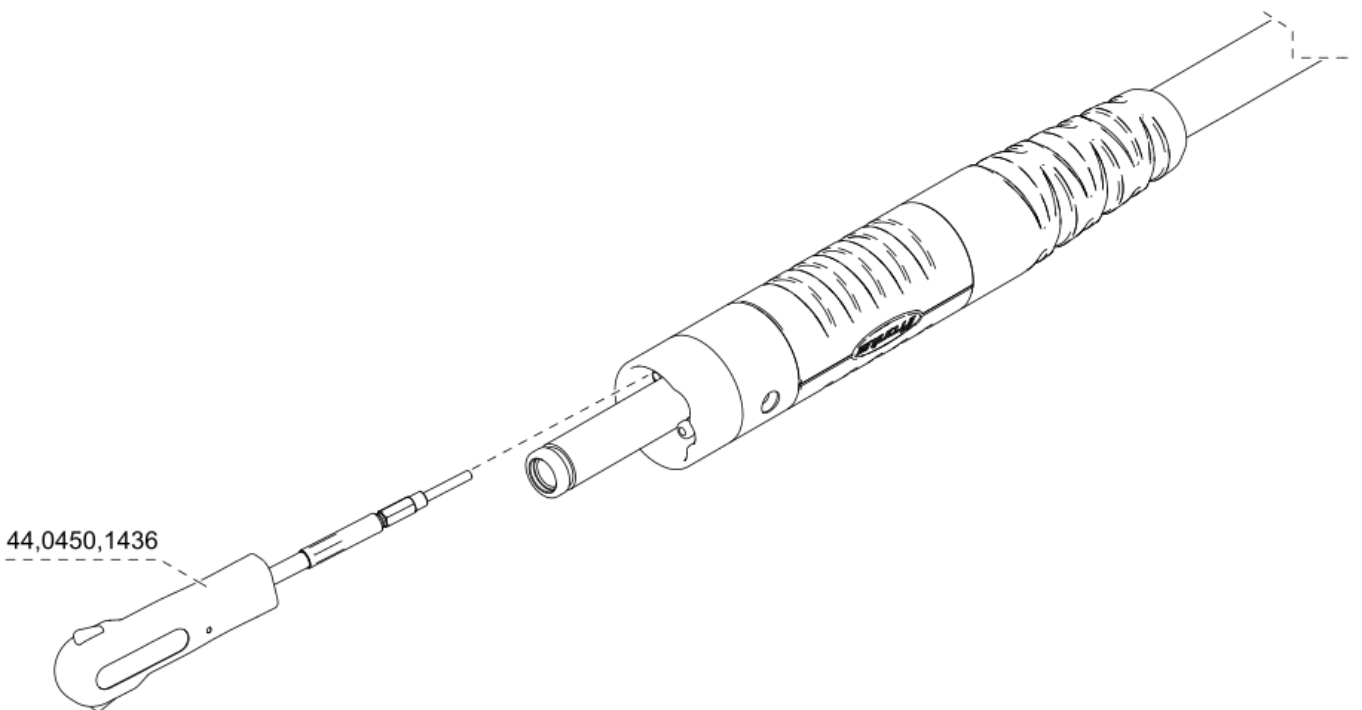
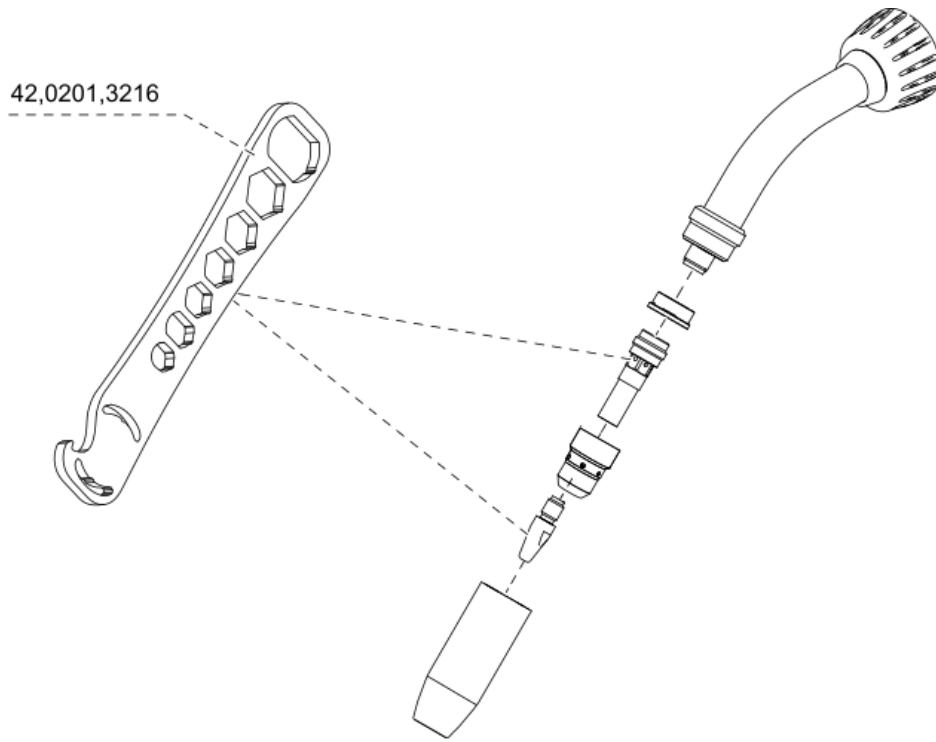

## MTG 2500S /FSC/3.5m/45° (4,035,980)

Article no.	Description	Quantity	Unit
42,0001,4608	Nozzle fit.M6/SW9x31/Ø13.5 MS	1	pc
44,0350,3865	Ins. sleeve ø12.2/ø17.7x17.5	1	pc
42,0001,4065	Gas nozzle ø13/ø22x58 CT	1	pc
42,0402,0258	O-ring 4x1.2mm FKM	1	pc
42,0407,0100	CABLE FIXING 150	1	pc
42,0001,4928	Contact tip 0.6/M6/8x24mm	1	pc
42,0001,6524	Contact tip 0,7 / M6 / 8x24mm ,10	1	pk
42,0001,4461	Contact tip 0,8/M6/ø8x24 ,10	1	pk
42,0001,4462	Contact tip 0,9/M6/ø8x24 ,10	1	pk
42,0001,4463	Contact tip 1,0/M6/ø8x24 ,10	1	pk
42,0001,6527	Contact tip 1,1 / M6 / 8x24mm ,10	1	pk
42,0001,4464	Contact tip 1,2/M6/ø8x24 ,10	1	pk
42,0001,6529	Contact tip 1,3 / M6 / 8x24mm ,10	1	pk
42,0001,4465	Contact tip 1,4/M6/ø8x24 ,10	1	pk
42,0001,6522	Contact tip 1,5 / M6 / 8x24mm ,10	1	pk
42,0001,4466	Contact tip 1,6/M6/ø8x24 ,10	1	pk
42,0001,6482	Contact tip 0,7/M8x1,5/10x32mm ,10	1	pk
42,0001,6464	Contact tip 0,8/M8x1,5/ø10x32 ,10	1	pk
42,0001,6465	Contact tip 0,9/M8x1,5/ø10x32 ,10	1	pk
42,0001,6466	Contact tip 1,0/M8x1,5/ø10x32 ,10	1	pk
42,0001,6483	Contact tip 1,1/M8x1,5/10x32mm ,10	1	pk
42,0001,6467	Contact tip 1,2/M8x1,5/ø10x32 ,10	1	pk
42,0001,6484	Contact tip 1,3/M8x1,5/10x32mm ,10	1	pk
42,0001,6468	Contact tip 1,4/M8x1,5/ø10x32	1	pk

## MTG 2500S /FSC/3.5m/45° (4,035,980)

Article no.	Description	Quantity	Unit
,10			
42,0001,6485	Contact tip 1,5/M8x1,5/10x32mm	1	pk
,10			
42,0001,6469	Contact tip 1,6/M8x1,5/ø10x32	1	pk
,10			
42,0001,6470	Contact tip 1,8/M8x1,5/ø10x32	1	pk
,10			
42,0001,6471	Contact tip 2,0/M8x1,5/ø10x32	1	pk
,10			
42,0001,6472	Contact tip 2,4/M8x1,5/ø10x32	1	pk
,10			
42,0001,4642	Contact tip 2.8/M8x1.5/ø10x32	1	pk
,10			
42,0001,6537	Cont. tip 0.8/M8x1.5/10x32 Al	1	pk
,10			
42,0001,4750	Cont. tip 1.0/M8x1.5/ø10x32 Al	1	pk
,10			
42,0001,4751	Cont. tip 1.2/M8x1.5/ø10x32 Al	1	pk
,10			
42,0001,4752	Cont. tip 1.6/M8x1.5/ø10x32 Al	1	pk
,10			
42,0001,6525	Contact tip 0,8 / M6 / 8x24mm	1	pk
,10			
42,0001,6526	Contact tip 1,0 / M6 / 8x24mm	1	pk
,10			
42,0001,6528	Contact tip 1,2 / M6 / 8x24mm	1	pk
,10			
42,0001,6523	Contact tip 1,6 / M6 / 8x24mm	1	pk
,10			
42,0001,7025	Contact tip 0.9/M6/ø8x24/SQ	1	pk
,10			
42,0001,7026	Contact tip 1.0/M6/ø8x24/SQ	1	pk
,10			
42,0001,7027	Contact tip 1.2/M6/ø8x24/SQ	1	pk
,10			
42,0001,7028	Cont. tip 0.9/M8x1.5/ø10x32/SQ	1	pk
,10			
42,0001,7029	Cont. tip 1.0/M8x1.5/ø10x32/SQ	1	pk
,10			
42,0001,7030	Cont. tip 1.2/M8x1.5/ø10x32/SQ	1	pk
,10			
42,0001,4055	Gas nozzle cyl ø18/ø22x58 CT	1	pc

## MTG 2500S /FSC/3.5m/45° (4,035,980)

Article no.	Description	Quantity	Unit
42,0001,4084	Gas nozzle ø10/ø22x58 CT	1	pc
42,0001,4083	Gas nozzle ø10/ø22x54 CT	1	pc
42,0001,4493	Gas nozzle ø15/ø22x58 CT	1	pc
42,0001,4477	Gas nozzle ø13/ø22x56 CT	1	pc
42,0001,4498	Gas nozzle ø13/ø22x56 CT/C	1	pc
44,0350,4128	Gas nozzle ø12xø20x59	1	pc
44,0350,3314	Clamping nipple 0.8 Al / CuSi	1	pc
44,0350,3315	Clamping piece 0.8 Fe / CrNi	1	pc
44,0350,3318	Clamping piece 1.2	1	pc
44,0350,3320	Clamping piece 1.4/1.6	1	pc
44,0350,3317	Clamping piece 0.9 / 1.0	1	pc
44,0350,3321	Clamping piece 2.0 Al	1	pc
42,0001,4589	Clamping piece 2.8 SSFCW	1	pc
44,0350,4245	Clamping piece 2.4 Al	1	pc
44,0350,3410	Combi liner G Al /1.2/4.8m	1	pc
44,0350,3403	Combi liner G Al /1.6/2.0m	1	pc
44,0350,3407	Combi liner G Al /1.6/3.8m	1	pc
44,0350,3411	Combi liner G Al /1.6/4.8m	1	pc
44,0350,3405	Combi liner G Al /1.0/3.8m	1	pc
44,0350,3409	Combi liner G Al /1.0/4.8m	1	pc
44,0350,3402	Combi liner G Al /1.2/2.0m	1	pc
44,0350,3406	Combi liner G Al 1.2/3.8m	1	pc
44,0350,3620	Combi liner G Al /2.0/4.8m	1	pc
44,0350,3619	Combi liner G Al /2.0/3.8m	1	pc
44,0350,3400	Combi liner G Al /0.8/2.0m	1	pc
44,0350,3404	Combi liner G Al /0.8/3.8m	1	pc
44,0350,3408	Combi liner G Al /0.8/4.8m	1	pc
44,0350,3401	Combi liner G Al /1.0/2.0m	1	pc
44,0350,5520	Combination liner G /1.2/4.8m	1	pc
44,0350,5516	Combination liner G /1.6/3.8m	1	pc
44,0350,5521	Combination liner G /1.6/4.8m	1	pc
44,0350,5514	Combination liner G /1.0/3.8m	1	pc
44,0350,5519	Combination liner G /1.0/4.8m	1	pc
44,0350,5515	Combination liner G /1.2/3.8m	1	pc

## MTG 2500S /FSC/3.5m/45° (4,035,980)

Article no.	Description	Quantity	Unit
44,0350,5517	Combination liner G /2.0/3.8m	1	pc
44,0350,5513	Combination liner G /0.8/3.8m	1	pc
44,0350,5518	Combination liner G /0.8/4.8m	1	pc
42,0404,0453	Bronze liner 2.7x1.0x40mm	1	pc
42,0404,0192	Bronze inner liner 2,7x1 0,32m	1	pc
42,0100,1370	Connector uni. to liner	1	pc
42,0100,1369	Outlet part to liner MAG02	1	pc
44,0350,3392	Combi liner W Al /0.8/3.8m	1	pc
44,0350,3396	Combi liner W Al /0.8/4.8m	1	pc
44,0350,3393	Combi liner W Al /1.0/3.8m	1	pc
44,0350,3397	Combi liner W Al /1.0/4.8m	1	pc
44,0350,3394	Combi liner W Al /1.2/3.8m	1	pc
44,0350,3398	Combi liner W Al /1.2/4.8m	1	pc
44,0350,3395	Combi liner W Al /1.6/3.8m	1	pc
44,0350,3399	Combi liner W Al /1.6/4.8m	1	pc
44,0350,3616	Combi liner W Al /2.0/3.8m	1	pc
44,0350,3617	Combi liner W Al /2.0/4.8m	1	pc
40,0002,0040	Steel liner exposed 0.8/15m ,015	1	pc
40,0002,0041	Steel liner exposed 1.0 / 15m ,015	1	pc
40,0002,0042	Steel liner exposed 1.2/15m ,015	1	pc
40,0002,0043	Steel liner exposed 1.6/15m ,015	1	pc
40,0002,0044	CrNi liner exposed 0.8/15m ,015	1	pc
40,0002,0045	CrNi liner exposed 1.0/15m ,015	1	pc
40,0002,0046	CrNi liner exposed 1.2/15m ,015	1	pc
40,0002,0047	CrNi liner exposed 1.6/15m ,015	1	pc
40,0002,0052	Steel inner liner C 0.8 / 15 m ,015	1	pc
40,0002,0053	Steel inner liner C 1.0 / 15 m ,015	1	pc
40,0002,0054	Steel inner liner C 1.2 / 15 m ,015	1	pc

## MTG 2500S /FSC/3.5m/45° (4,035,980)

Article no.	Description	Quantity	Unit
40,0002,0055 ,015	Steel inner liner C 1.6 / 15 m	1	pc
40,0002,0040 ,005	Steel liner exposed 0.8/5m	1	pc
40,0002,0041 ,005	Steel liner exposed 1.0/5m	1	pc
40,0002,0042 ,005	Steel liner exposed 1.2/5m	1	pc
40,0002,0043 ,005	Steel liner exposed 1.6/5m	1	pc
40,0002,0044 ,005	CrNi liner exposed 0.8/5m	1	pc
40,0002,0045 ,005	CrNi liner exposed 1.0/5m	1	pc
40,0002,0046 ,005	CrNi liner exposed 1.2/5m	1	pc
40,0002,0047 ,005	CrNi liner exposed 1.6/5m	1	pc
40,0002,0052 ,005	Steel inner liner C 0.8 / 5 m	1	pc
40,0002,0053 ,005	Steel inner liner C 1.0 / 5 m	1	pc
40,0002,0054 ,005	Steel inner liner C 1.2 / 5 m	1	pc
40,0002,0055 ,005	Steel inner liner C 1.6 / 5 m	1	pc
40,0002,0040 ,050	Steel liner exposed 0.8/50m	1	pc
40,0002,0041 ,050	Steel liner exposed 1.0/50m	1	pc
40,0002,0042 ,050	Steel liner exposed 1.2/50m	1	pc
40,0002,0043 ,050	Steel liner exposed 1.6/50m	1	pc
40,0002,0044 ,050	CrNi liner exposed 0.8/50m	1	pc
40,0002,0045 ,050	CrNi liner exposed 1.0/50m	1	pc
40,0002,0046 ,050	CrNi liner exposed 1.2/50m	1	pc
40,0002,0047 ,050	CrNi liner exposed 1.6/50m	1	pc
40,0002,0052	Steel inner liner C 0.8 / 50 m	1	pc



## MTG 2500S /FSC/3.5m/45° (4,035,980)

Article no.	Description	Quantity	Unit
,050			
40,0002,0053 ,050	Steel inner liner C 1.0 / 50 m	1	pc
40,0002,0054 ,050	Steel inner liner C 1.2 / 50 m	1	pc
40,0002,0055 ,050	Steel inner liner C 1.6 / 50 m	1	pc
44,0350,3388	Combi liner W Al /0.8/2.0m	1	pc
44,0350,3389	Combi liner W Al /1.0/2.0m	1	pc
44,0350,3390	Combi liner W Al /1.2/2.0m	1	pc
44,0350,3391	Combi liner W Al /1.6/2.0m	1	pc
44,0350,5550	Kombiseele G /0,8/2,0m	1	pc
44,0350,5552	Kombiseele G /1,2/2,0m	1	pc
44,0350,5553	Kombiseele G /1,6/2,0m	1	pc
44,0350,5522	Combination liner G /2.0/4.8m	1	pc
44,0350,5554	Kombiseele G /2,0/2,0m	1	pc
44,0350,3615	Combi liner W Al /2.0/2.0m	1	pc
44,0350,3618	Combi liner G Al /2.0/2.0m	1	pc
44,0350,5551	Kombiseele G /1,0/2,0m	1	pc
40,0001,0529 ,010	Graph. liner 0.8(4.7/1.2) 10m	1	pc
40,0001,0530 ,010	Graph. liner 1.0(4.7/1.5) 10m	1	pc
40,0001,0531 ,010	Graph. liner 1.2(4.7/1.8) 10m	1	pc
40,0001,0532 ,010	Graph. liner 1.6(4.7/2.4) 10m	1	pc
40,0001,0529 ,100	Graph. liner 0.8(4.7/1.2) 100m	1	pc
40,0001,0531 ,100	Graph. liner 1.2(4.7/1.8) 100m	1	pc
40,0001,0530 ,100	Graph. liner 1.0(4.7/1.5) 100m	1	pc
40,0001,0533 ,100	Graph. liner 2.0(4.7/3.0) 100m	1	pc
40,0001,0532 ,100	Graph. liner 1.6(4.7/2.4) 100m	1	pc
40,0001,0533 ,030	Graph. liner 2.0(4.7/3.0) 30m	1	pc
40,0001,0532	Graph. liner 1.6(4.7/2.4) 30m	1	pc

## MTG 2500S /FSC/3.5m/45° (4,035,980)

Article no.	Description	Quantity	Unit
,030			
40,0001,0531 ,030	Graph. liner 1.2(4.7/1.8) 30m	1	pc
40,0001,0530 ,030	Graph. liner 1.0(4.7/1.5) 30m	1	pc
40,0001,0529 ,030	Graph. liner 0.8(4.7/1.2) 30m	1	pc
40,0001,0533 ,010	Graph. liner 2.0(4.7/3.0) 10m	1	pc
44,0350,5144	BK Al ø0.8 /G CuSi ø0.8 G/W/5m	1	pc
44,0350,5145	BK Al ø0.9 /G CuSi ø0.9 G/W/5m	1	pc
44,0350,5146	BK Al ø1.0 /G CuSi ø1.0 G/W/5m	1	pc
44,0350,5147	BK Al ø1.2 /G CuSi ø1.2 G/W/5m	1	pc
44,0350,5148	BK Al ø1.4 /G CuSi ø1.4 G/W/5m	1	pc
44,0350,5149	BK Al ø1.6/G CuSi ø1.6 G/W/5m	1	pc
44,0350,5135	BK Al ø0.8 /W/5m	1	pc
44,0350,5136	BK Al ø0.9 /W/5m	1	pc
44,0350,5137	BK Al ø1.0 /W/5m	1	pc
44,0350,5138	BK Al ø1,2 W/5m MTW	1	pc
44,0350,5139	BK Al ø1.4 /W/5m	1	pc
44,0350,5140	BK Al ø1.6 /W/5m	1	pc
44,0350,5141	BK Al ø2.0 /W/5m	1	pc
44,0350,5163	BK CrNi ø1.6 /G/W/5m	1	pc
44,0350,5162	BK CrNi ø1.4 /G/W/5m	1	pc
44,0350,5160	BK CrNi ø1,0 G/W/5m MTG/MTW	1	pc
44,0350,5161	BK CrNi ø1,2 G/W/5m MTG/MTW	1	pc
44,0350,5159	BK CrNi ø0.9 /G/W/5m	1	pc
44,0350,5158	BK CrNi ø0.8 /G/W/5m	1	pc
44,0350,5296	BK Fe ø0,6 /G/W/5m	1	pc
44,0350,5117	BK Fe ø0.8 /G/W/5m	1	pc
44,0350,5118	BK Fe ø0.9 /G/W/5m	1	pc
44,0350,5119	BK Fe ø1,0 G/W/5m MTG/MTW Fe	1	pc
44,0350,5120	BK Fe ø1,2 G/W/5m MTG/MTW Fe	1	pc
44,0350,5121	BK Fe ø1.4 /G/W/5m	1	pc
44,0350,5122	BK Fe ø1.6 /G/W/5m	1	pc
44,0450,1436	Extract. tool CPC+35mm extens.	1	pc

## MTG 2500S /FSC/3.5m/45° (4,035,980)

Article no.	Description	Quantity	Unit
42,0201,3216	Multitool TB wear parts	1	pc