

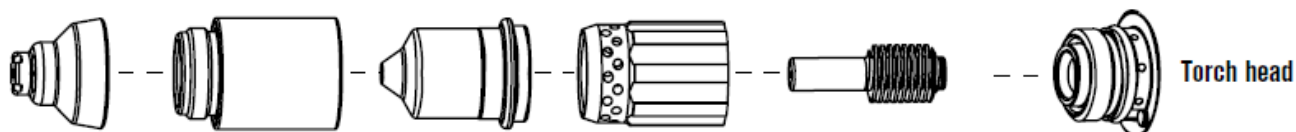

# HYPERTHERM CONSUMABLES FOR THE T45 TORCH

## Shielded consumables



Shield	Retaining cap	Nozzle	Swirl ring	Electrode
220674	220713	220671	220670	220669

## Unshielded\* consumables

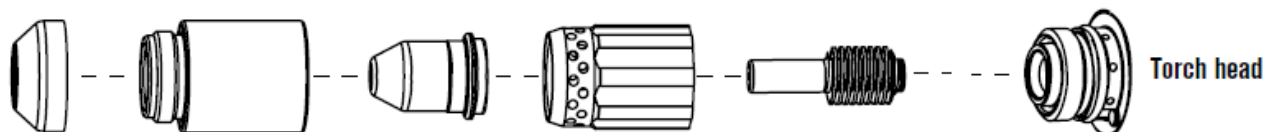

Deflector	Retaining cap	Nozzle	Swirl ring	Electrode
220717	220713	220718	220670	220669

## Gouging consumables

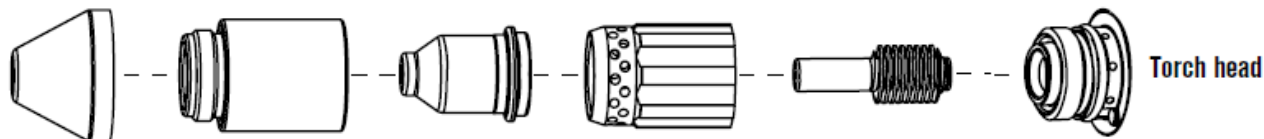

Shield	Retaining cap	Nozzle	Swirl ring	Electrode
220675	220713	220672	220670	220669

## T30v consumables\*\*

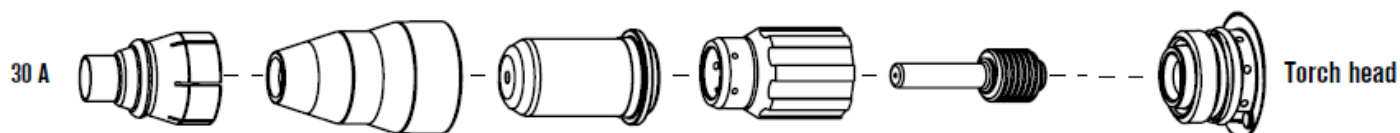

30 A	Deflector (optional)	Retaining cap	Nozzle	Swirl ring	Electrode
30 A	220569	220483	220480	220479	220478

