

# clearmaxx

Clear view. Clear air.



QUICK START GUIDE.....	2
FUNCTIONS.....	4
SPARE PARTS.....	6
ENGLISH.....	7
FRANÇAIS.....	8
DEUTSCH.....	9
SVENSKA.....	10
ITALIANO.....	11
ESPAÑOL.....	12
PORTUGUÊS.....	13
NEDERLANDS.....	14
SUOMI.....	15
DANSK.....	16
NORSK.....	17
POLSKI.....	18
ČEŠTINA.....	19
PYCCKNN.....	20
中文.....	21
MAGYAR.....	22
TÜRKÇE.....	23
日本語.....	24
ΕΛΛΗΝΙΚΑ.....	25
БЪЛГАРСКИ.....	26
SLOVENSKÝ.....	27
SLOVENSKI.....	28
ROMÂNĂ.....	29
EESTI.....	30
LIETUVIŠKAI.....	31
LATVIEŠU.....	32
MALTI.....	33
GAEILGE.....	34
HRVATSKI.....	35

1

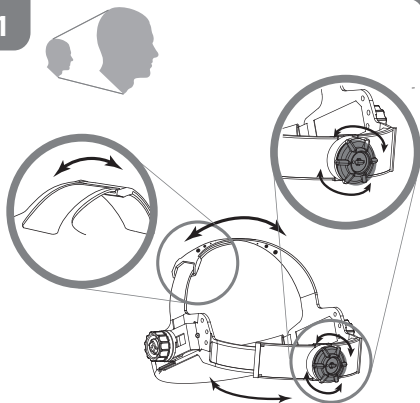

2

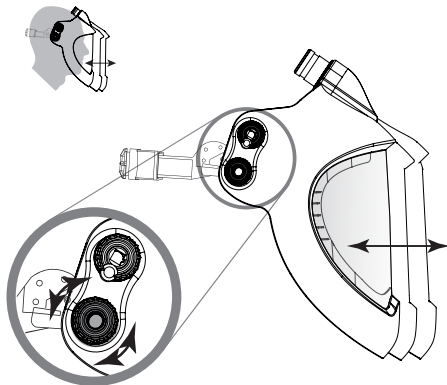

5 B



clearmaxx PAPR

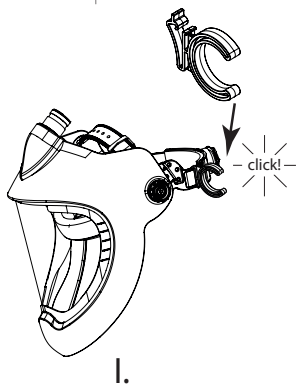

I.

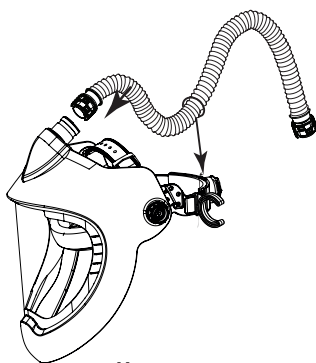

II.

**clear**  
Quick Sta

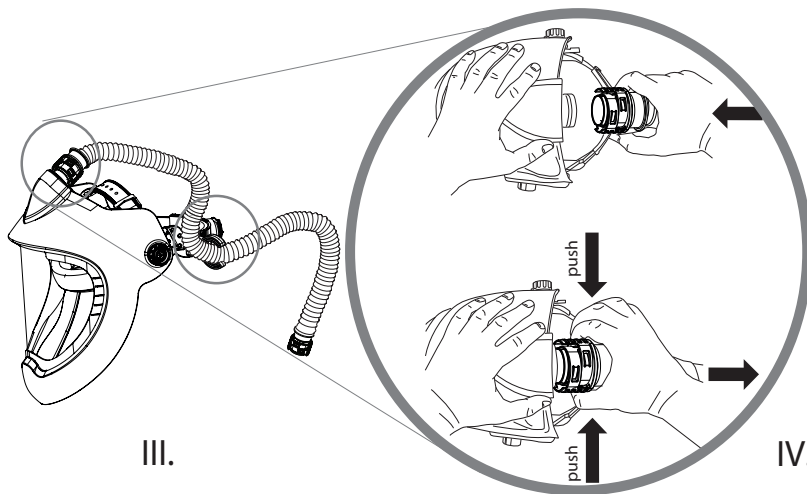

III.

Air distribution  
**on**

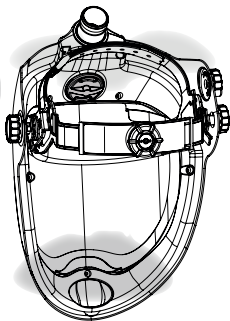

IV.

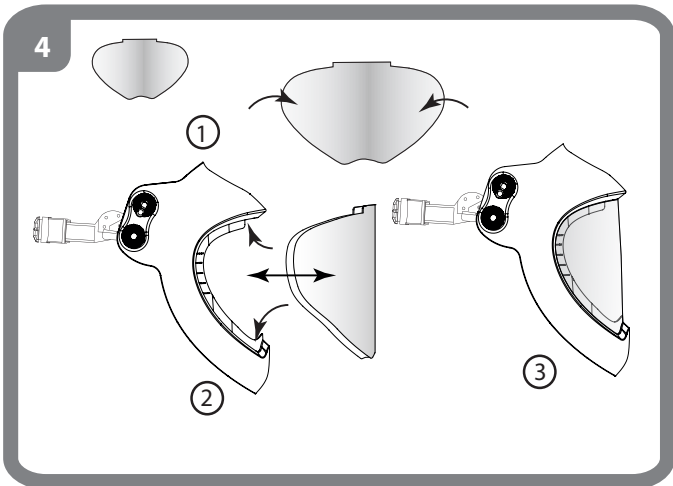
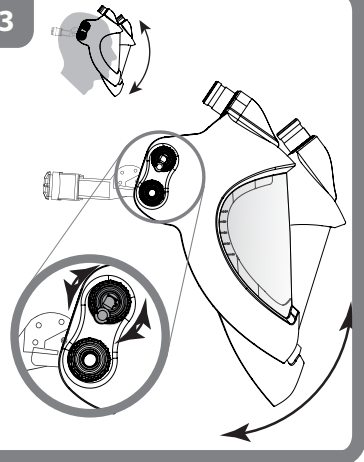

# maxx

## Start Guide

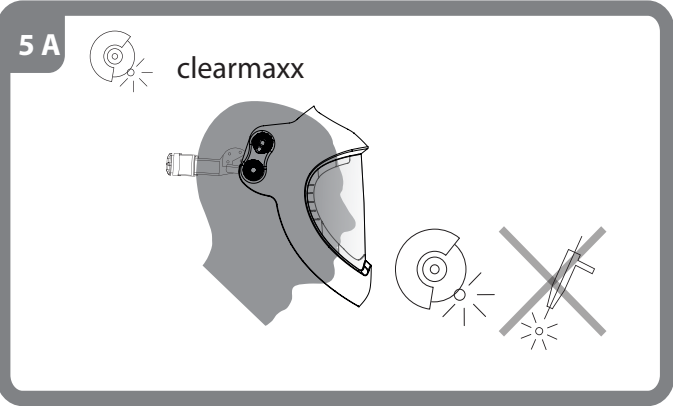

### control

off

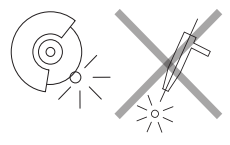
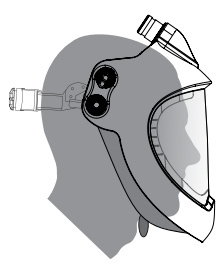
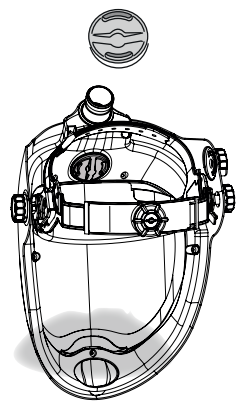

VI.

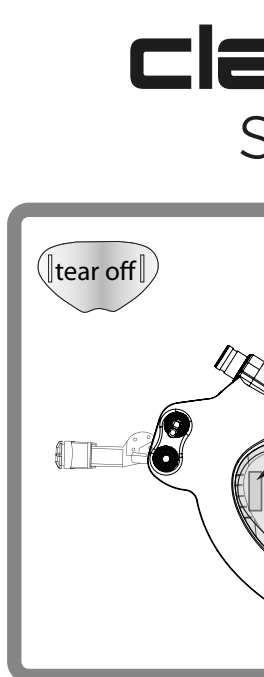
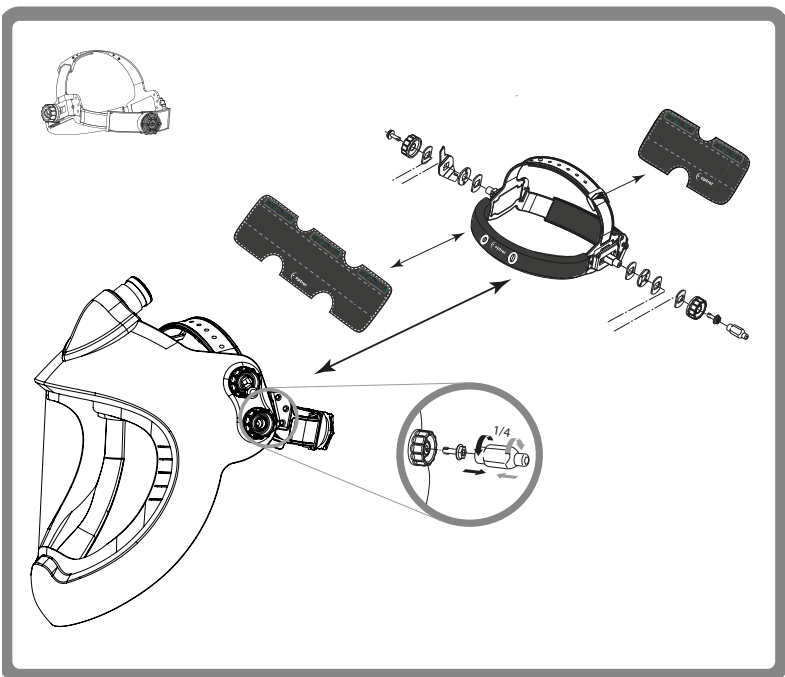
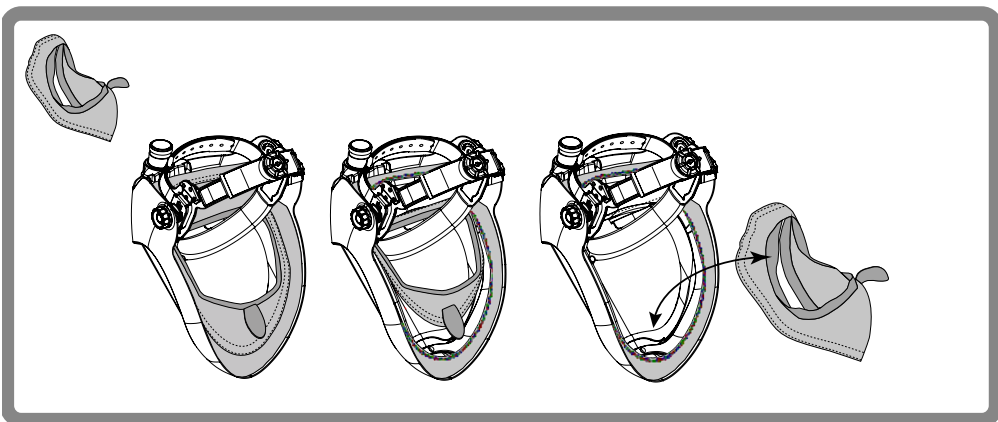
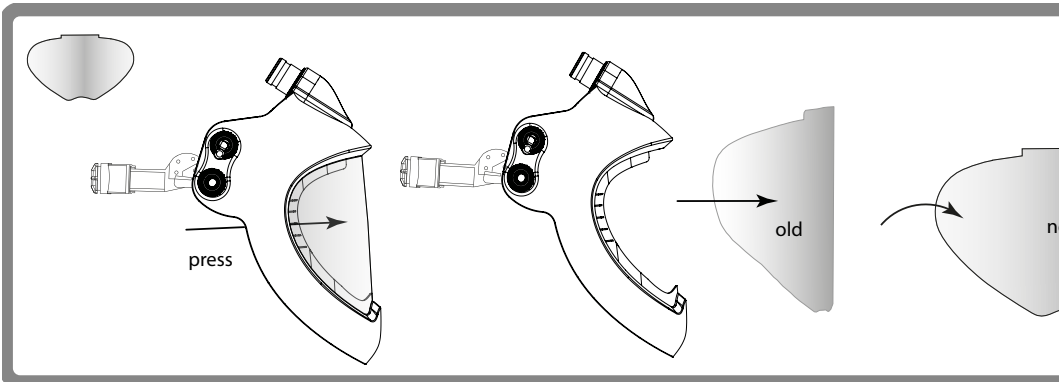



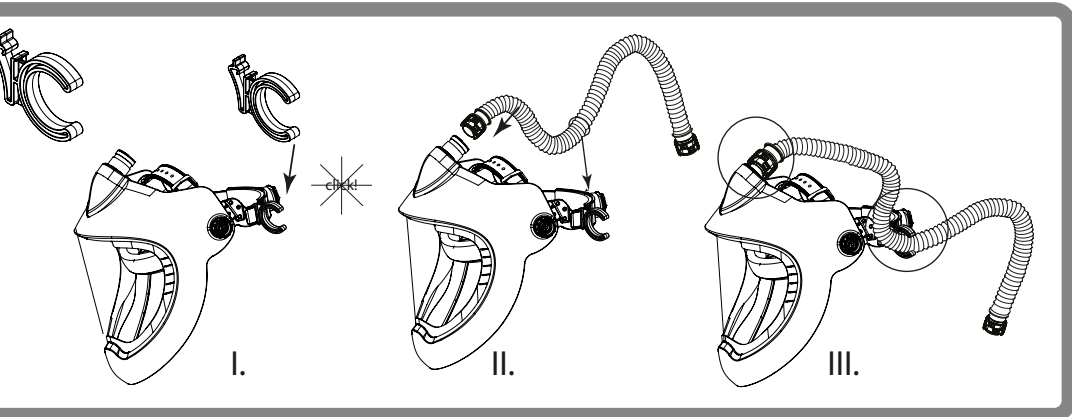
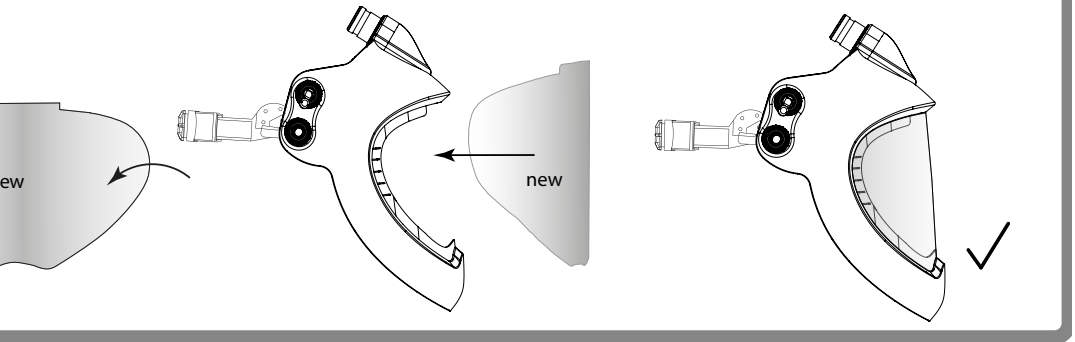





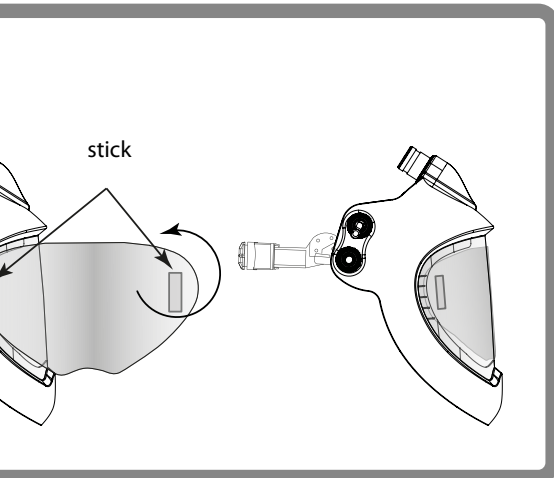



cle  
S



# earmaxx

## spare parts



	article list
	1011.000
PAPR 	4900.020
	5000.038
	5000.039
	4551.024
	5003.263
	4156.010
	5004.073
	5004.020
	5002.900



# English

## Introduction

A grinding helmet is a headgear used to protect eyes, face and neck from dust and particles during grinding. The helmet consists of several parts (see spare parts list). Depending on the model, the helmet can be combined with a safety helmet and / or a PAPR system (Powered Air Purifying Respirator).

## Safety instructions

Read these operating instructions carefully before using the equipment. Incorrect use could endanger life and limb and void warranty claims against the manufacturer.

## Performance of the PPE / Applications / Risks

An unlimited clear view of your workplace with or without filtered air distribution (depending on the model) with adjustable air distribution makes the clearmaxx a unique face and respiratory protection system with the highest level of safety. Spare parts and accessories see Quick Start Guide.

Ideal for: Grinding applications, metal industry, food industry, sand blasting, wood applications, painting, landfills and agriculture.

In case of high air moisture content or major temperature differences, the visor can fog up thus causing impaired vision. If the mechanical seal is incorrectly installed or defective, there is a risk of air pollutants entering the helmet (PAPR version). Further risks / restrictions see below.

## Precautions and protective restrictions

- Before using the product, always check that the equipment is complete and that no damage has occurred during transport. Never use faulty or damaged equipment.
- The user must be familiar with the correct use of his/her personal protective equipment.

## PAPR version only:

- The user of this head gear must also follow the instructions for the PAPR system and the filters.
- Use the anti-fog visor only in conjunction with a switched-on PAPR system.
- The helmet should only be used in conjunction with a certified ventilator that meets the requirements of national standards.
- The filtered air overpressure in the protective head gear is the primary protection factor that prevents the ingress of air pollutants.
- A disabled PAPR system does not protect the user's respiratory organs. A switched off ventilator could lead to an increase in the carbon dioxide concentration and to a dangerous drop in oxygen in the head gear.
- Make sure that the sealing line of the head gear is pressed firmly against your face; this is the only way to guarantee a perfect level of protection.
- The protection factor may be impaired if the user's hair or beard protrudes onto the mechanical seal part.
- Strong wind from the side or back can impair the protection offered by the helmet. In the event of extremely high levels of environmental particle contamination, inhalation may cause very low pressure in the helmet. This could impair the protection. In this case, do not remove the helmet or switch off the fan until you have left the danger area.

## The fog-free clearmaxx visor must not be used:

- in a flammable or explosive atmosphere,
- if the inhaled air lacks oxygen (Europe: <17%, Australia <19%) or the toxin concentration is so high that the protection class is above TH3P for Europe and above P3 for Australia, in environments where there is an imminent danger to life and limb.

You must also wear appropriate protective clothing to protect the rest of your body. In some circumstances, particles or substances released by work processes can cause allergic skin reactions in susceptible individuals.

Helmet materials that come into contact with the skin can cause allergic reactions in sensitive individuals. The anti-fog protective visor may only be used for grinding and for applications where particles, smoke or dust which can damage the respiratory tract are generated. Never use the helmet for other applications. The helmet can affect the field of view due to constructive features. As a result, signal lights or warning lights may not be seen. Furthermore, there is a risk of bumping due to the larger circumference (head with helmet). The helmet also impairs hearing and reduces the sensation of heat. The manufacturer shall not be liable if the anti-fog visor is used for any purpose other than the intended purpose or in violation of the operating instructions.

## Warranty & liability

For the warranty conditions, please refer to the instructions provided by your national sales organisation. For more information, please contact your retailer. The warranty only applies to material and manufacturing defects. In the event of damage caused by unintended use, tampering or any use not intended by the manufacturer, the warranty or liability shall be void. Similarly, liability and warranty are void if spare parts other than those sold by the manufacturer are used.

## Estimated service life

The anti-fog visor does not have an expiration date. The product can be used as long as no visible or invisible damage or malfunctions occur.

## How to use (Quick Start Guide) p. 2-3

## Both Models (Standard and PAPR):

1. Head strap. Set the upper adjusting strap (p. 2-3) to suit your head size. Push in the locking knob (p. 2-3) and turn it until the head strap is fitting securely but without applying pressure.
2. Distance from eyes. The distance between the protective glass and the eyes can be adjusted by releasing the locking knobs (p. 2-3). Adjust both sides equally and do not tilt. Then tighten the locking knobs again.
3. Helmet angle. The helmet angle can be adjusted using the rotary knob (p. 2-3).
4. Fastening the visor. Fasten the lower part of the visor in the corresponding opening. Then slide the upper part of the visor under the upper edge of the visor. Push the side edges of the visor into the lower grooves. (p. 2-3).

## PAPR Version only:

- I-III Air hose holder. Click the air hose holder onto the headgear following the illustrations (p. 2-3) Step I. Connect the air hose to the helmet (steps II and III) and click the air hose into the air hose holder to fit in place.
- IV Air distribution. The air flow distribution can be adjusted from 100% in the breathing zone to 80% in the breathing zone and 20 % in the forehead zone to generate a cooling effect (p. 2-3).
- V Faceseal. Turn the adjusted helmet upside down and pull the mechanical seal strip under your chin. Make sure that the mechanical seal sits flush against your skin and that there is no leakage (p. 2-3).

## Cleaning, disinfection and Maintenance

### non PAPR and PAPR version:

Check your personal protective equipment (PPE) regularly in accordance with the operating instructions. Use a clean cloth moistened with soapy water to clean the fog-free visor inside and out. Let the helmet dry in a clean environment. Replace sweatbands and comfort bands regularly for reasons of hygiene.

### PAPR version:

Clean the ventilator, air hose and safety helmet with a clean cloth moistened with soapy water. Let the appliance dry at room temperature. Do not use strong detergents, solvents, alcohol or cleaners that contain abrasives. The mechanical seal is washable (hand wash, do not spin).

Check the mechanical seal and the air nozzle for holes, cracks or other damage and ensure that they are correctly positioned on the helmet (see operating instructions). Do not use the system until all worn or damaged parts have been replaced.

Clean the outside and inside of the clearmaxx with a damp cloth and soapy water. The mechanical seal (PAPR version) should either be removed and washed by hand or carefully wiped off while fitted to the helmet. Use soapy water or a mild disinfectant. Replace the mechanical seal from time to time.

## Storage

The anti-fog visor must be stored at room temperature and low humidity. Store the helmet in the original packaging or in a dedicated backpack or in a PAPR bag increases the service life.

## Removing / installing the visor (p. 4-5)

### Removing the visor:

- Pull the lower part of the visor edge.
- Simultaneously push out starting at the bottom inside of the visor.

### Attaching the visor:

- Fasten the lower part of the visor in the corresponding opening.
- Slide the upper part of the visor under the upper edge of the visor.
- Push the side edges of the visor into the lower grooves.

### Replacing the mechanical seal (PAPR version only)

- Remove the washable part of the mechanical seal by carefully pulling apart the hook and loop fastener.
  - The removable part of the mechanical seal is washable (hand wash, do not spin).
  - Clean the fixed part of the mechanical seal with a clean cloth moistened with soapy water or a mild disinfectant.
  - Allow to dry in the air and assemble in reverse order.
- Never use a damaged mechanical seal.  
Replace the mechanical seal every six months.

## Technical data

(We reserve the right to make technical changes at any time)

Weight	non PAPR: 334g / 11,782 oz PAPR: 500g / 17,637 oz
Material	Helmet shell: Polyamide Visor: Polycarbonate
Operating temperature	- 10°C bis + 55°C / 14°F bis 131°F
Storage temperature	- 20°C to + 80°C / - 4°F to 176°F
Shape stability	Helmet shell: up to 220°C / 428°F Visor: up to 137°C / 279°F
Markings:	OS EN 175 BT (Helmet Shell) OS EN 166 BT (Visor) complies with CSA Z94.3 ANSI OS Z87+ EAC
Additional markings for PAPR version (notified body CE 1024)	EN 12941 (TH3 in combination with e3000/X, TH1 in combination with hardhat and e3000/X) EN 14594 (2B in combination with suppliedair, 1B in combination with hardhat and suppliedair)

## Declaration of conformity

See the Internet address on the last page.

## Legal information

This document complies with the requirements of EU Regulation 2016/425 section 1.4 of Annex II.

## Notified body

For detailed information see last page.